

Brandt



GUIDE TO INSTALLATION EN
GUIDE D'UTILISATION FR
MANUAL DE UTILIZAÇÃO PT
BEDIENUNGSANLEITUNG DE
NÁVOD K POUŽITÍ CZ
INSTALLATIONSVEJLEDNING DK
GUIDE FÖR INSTALLATION SE
ΟΔΗΓΟΣ ΕΓΚΑΤΑΣΤΑΣΗΣ GR
MANUAL DE UTILIZACIÓN ES
ASENNUSOHJEET FI
MANUAL FOR INSTALLASJON NO

Decorative Hood
Hotte decorative
Exaustor decorative
Dekorative Dunstabzugshaube
Dekorativní odsavač par
Dekorativ emhætte
Dekorativ spiskåpa
Διακοσμητικός απορροφητήρας
Campana extractor decorativa
Koristekupu
Dekorativ hette



TABLE OF CONTENTS

EN

1 / NOTICES TO THE USER	
• Safety recommendations _____	4
• Environmental protection _____	9
• Description of your appliance _____	10
2 / INSTALLING YOUR APPLIANCE	
• Assembling the hood _____	11
3 / USING YOUR APPLIANCE	
• To use your cooker hood _____	13
4 / CARING FOR AND CLEANING YOUR APPLIANCE	
• Changing and cleaning the anti-grease filters _____	15
• Installing the carbon filter _____	15
• Changing the light bulb _____	15
• Maintaining your appliance _____	16
5 / TROUBLESHOOTING _____	17
6 / AFTER-SALES SERVICE _____	17

**Attention**

Keep this user guide with your appliance. If the appliance is ever sold or transferred to another person, ensure that the new owner receives the user guide. Please become familiar with these recommendations before installing and using your appliance. They were written for your safety and the safety of others.

Safety and important precautions



These instructions are also available on the Brandt web site.

Please take heed of this advice when installing and using your appliance. These instructions are intended to protect your safety and the safety of others. Keep this manual with your appliance. If you sell or give the appliance to anyone else, make sure that you also give them this manual.

- In order to constantly improve our products, we reserve the right to make changes to their technical, functional or aesthetic characteristics in line with technological progress.
- Make a note of the references of your appliance on the "Consumer Service" page so that you can readily find them in future.

Important precautions

- This appliance is designed for use by consumers in the home. Do not use it for commercial or industrial purposes or for any other purpose for which it is not intended.
- Unpack the appliance as soon as you receive it. Check its general appearance. Make a note of any reservations on the delivery slip and keep a copy.
- This appliance can be used by children aged under 8 and by persons with diminished physical, sensory or mental capacities, or persons without any experience or knowledge, provided that they are properly attended to or are given the instructions on how to use the appliance in complete safety and that any potential risks are anticipated. Children must not play with this appliance. The appliance must not be cleaned and maintained by unattended children.
- Caution: The accessible parts of this appliance may become hot when used with cooking equipment.

Electrical risks

- All the power supply circuits must be disconnected before touching the connection terminals. If the power cord is damaged, it must be

replaced by the manufacturer, its after-sales service or a similarly qualified person in order to avoid any danger.

- The appliance can be disconnected by using an accessible power outlet or by incorporating a switch in the fixed lines, in accordance with the installation rules.
- Do not change or attempt to change the characteristics of this appliance. Doing so can be dangerous.
- The appliance must only be repaired by an approved specialist.
- Always disconnect the hood before cleaning or maintaining it.
- Never use steam or high-pressure tools to clean your appliance (for the purposes of electrical safety).
- The appliance can be disconnected by using an accessible power outlet or by incorporating a switch in the fixed lines, in accordance with the installation rules.
- Do not change or attempt to change the characteristics of this appliance. Doing so can be dangerous.
- The appliance must only be repaired by an approved specialist.
- Always disconnect the the hood before clean

ing or maintaining it.

- Never use steam or high-pressure tools to clean your appliance (for the purposes of electrical safety).

Risk of asphyxiation

- The regulations applying to the evacuation of air must be obeyed. The air must not be sent into a duct used to evacuate fumes from appliances that use gas or other fuels (this does not apply to appliances that only emit air into the room).
- The room must be suitably ventilated when the range hood is used at the same time as appliances that use gas or other fuels (this does not apply to appliances that only emit air into the room).

Risk of fire

- It is forbidden to flambé food or to turn on gas rings that are not covered by a cooking recipient beneath the hood, as the flames may be sucked in and damage the appliance.
- Keep a constant eye on fryers used beneath the hood. When heated to very high temperatures, oil and fat can catch fire.
- Clean the appliance and replace the filters at

the recommended frequency. Accumulated deposits of grease can cause a fire.

- It is forbidden to use the hood above a fuel fire (wood, coal, etc.).
- If the hood is installed above a gas-fired appliance, leave at least 70 cm between the top of the range and the underside of the hood. If the instructions of the range installed under the hood specify a distance greater than 70 cm, then this distance must be respected.

**Warning**

In the case of a kitchen heated by a device connected to a chimney (a stove, for example) the “recycling” version of the hood should be installed. Do not use the hood without metal filters.

Suitable ventilation should be provided in the room when the hood is used at the same time as appliances operated by gas or another combustible fuel.

• ENVIRONMENTAL PROTECTION

— This appliance's packaging material is recyclable. Help recycle it and protect the environment by dropping it off in the municipal receptacles provided for this purpose.

— Your appliance also contains a great amount of recyclable material. It is marked with this label to indicate the used appliances that should not be mixed with other waste. This way, the appliance recycling organised by your manufacturer will be done under the best possible conditions, in compliance with European Directive 2002/96/EC on Waste Electrical and Electronic Equipment. Contact your town hall or your retailer for the used appliance collection points closest to your home.



— We thank you doing your part to protect the environment.

**Warning**

Installation should only be performed by installers and qualified technicians.

**Warning**

Remove the protective film from the cartridge filter before use.

- **DESCRIPTION OF YOUR APPLIANCE**

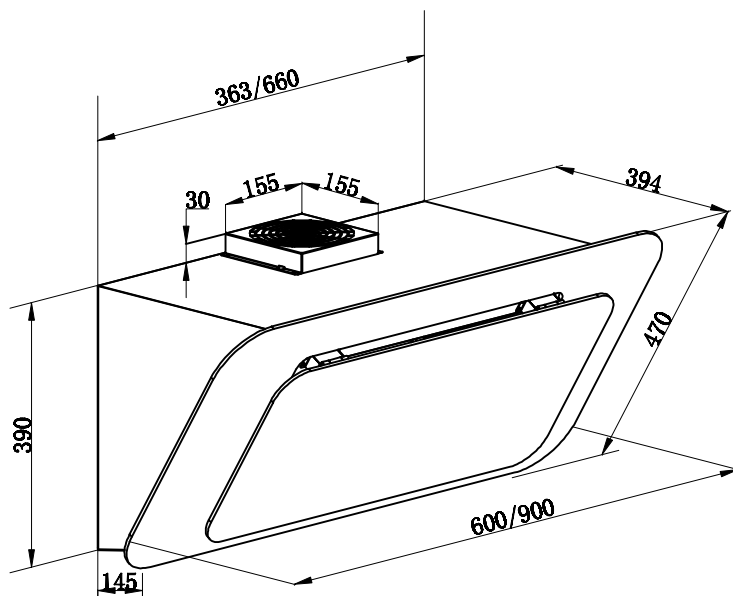

• ASSEMBLING THE HOOD

— The cooker hood should be placed at a distance of 65-75cm (26-30inch) from the cooking surface for the best effect.

See Pic 1.

• Recycling Mode

— Install the hook on a suitable place once the installation height is fixed, and keep it in line. See Pic 2.

— Take out aluminum filter and install the carbon filter on the both sides of motor.

See Pic 3

— Put the cooker hood on the hook. After adjusting the position, fix the body with safty screw. See Pic 4.



Note

The two safty vents are positioned on the back casing, with diameter of 6mm



Note

Any installation work must be carried out by a qualified electrician or competent person.

— Do not connect the ducting system of the hood to any existing ventilation system which is being used for any other appliance, such as warmer tube, gas tube, hot wind tube.

— The angle of the bend of the ventilation pipe should not be less than 120°; you must direct the pipe horizontally, or, alternatively, the pipe should go up from the initial point and should be led to an outer wall.

— After the installation, make sure that the cooker hood is level to avoid greasecollection at on end. See Pic. 5



Advice on how to save energy

To make optimal use of your appliance, keep the length of the duct and the number of bends in the duct to a strict minimum.

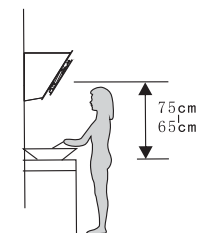

Pic 1

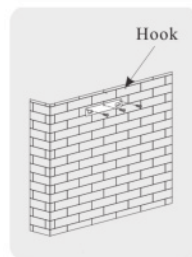

Pic 2

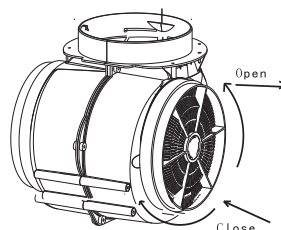

Pic 3

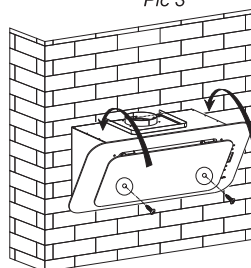

Pic 4

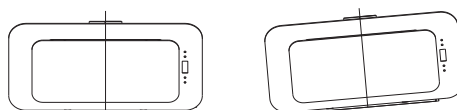

Right

Wrong

Pic 5

EN 2 / INSTALLING YOUR APPLIANCE

• Outdoor evacuation (optional)

- Install the hook on a suitable place once the installation height is fixed, and keep it in line. See Pic 2.
- Dismount the safe metal grip on the top of air outlet.
- Connect the extension tube (not included) to the air outlet. See Pic 6.
- Put the cooker hood on the hook. After Adjust the position, fix the body with safety screws. See Pic 7.
- Fix the flat bracket behind the outside chimney. See Pic 8.
- Fix the chimneys to the hood. Lift the upper chimney up to the ceiling and fix it to the bracket using the screws. See Pic 9.



Note

We recommend using chimney kit ATC-252X, which is sold separately.

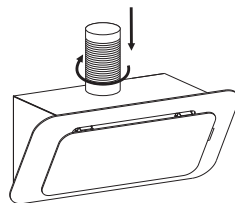

Pic 6

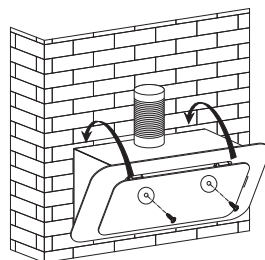

Pic 7

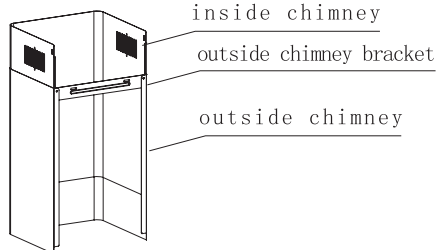

Pic 8

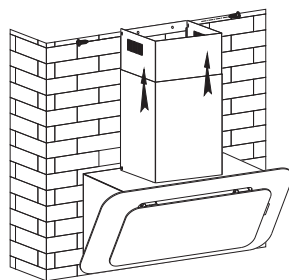



Pic 9

• TO USE YOUR COOKER HOOD

How to use the control panel

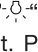
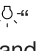
1. Plug the hood: When power-on, the backlight is lit. Then showing the “24-hour system”, the output is off, and the machine standby. Without any operation, the backlight disappear automatically after 30 seconds.

2. Press the “” button once, the lamp and the “” is lit. Press the button again, the lamp and the “” is lit will be disappear.



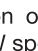
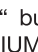
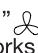
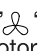

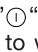
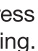
3. To use the Speed press the “” button. The motor has three speeds: Low, Medium, High.

- Press “” button once, the motor starts to work at LOW speed.
- Press “” button again, the motor works at MEDIUM speed.
- Press “” button one time more, the motor works at HIGH speed.
- When working, press “” button can select the speed of motor: “LOW-MEDIUM HIGH - LOW - MEDIUM...” circularly

4. Press the Power “” button once, the motor of hood starts to work at the speed it worked last time. Press “” button again, the motor stops working.

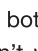
5. To use the Timer “” button:

The standard time setting is 12:00. When the hood is cut off, the time will return to 12:00 automatically, and you have to reset the time.

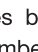
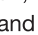
- When both “” button and “” button don't work, “” button is used for time-setting.
- Press “” button for 2 to 5 seconds, time segment “**88:88**”, and the first two number for hour setting will flash. Press “” button, the number increases by degrees, and press “”, the number

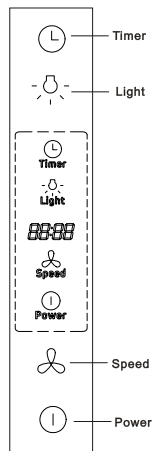

Pic 10

decreases by degrees. Namely, the variability is 01 each time when it is pressed once; And the largest digit is 23, the "⌘" button can't work when exceeded. If it is equal to 00, the "↺" button can't work.

— Press the Timer "⌚" button for the second time, time segment "88:88", and the last two number for minute setting will flash. Press "⌘" button, the number increases by degrees, and press "↺", the number decreases by degrees. Namely, the variability is 01 each time when it is pressed once; And the largest digit is 59, the "⌘" button can't work when exceeded. If it is equal to 00, the "↺" button can't work.

— Press the Timer "⌚" button for the third time, and it means time setting exit and confirmation.

— Long press the Timer "⌚" button for 2-5 seconds under mode, it is for hour setting. Press it for the second time: minute setting. Press it for the third time: time setting exit and confirmation. And it will repeat the action again and again when it is pressed.(It can't run this procedure, if the first time pressing doesn't exceed 2 seconds).



Advice on how to save energy

Adjust the speed to the cooking method and the number of pans in use. It is preferable to use the rings at the back of the range.

• CHANGING AND CLEANING THE ANTI-GREASE FILTERS

— Tear down your cooker hood as per the approach shown on *Pic.11*.

— You can clean the filter as below:

1. Soak them for about 3 minute in hot water (40-50 degrees) with a grease-loosening detergent then brush it gently with a soft brush. Please do not apply too much pressure ,avoid to damage it .
2. It can be put into a dishwasher with detergent ,set the temperature at around 60 degrees.

— Please do not use abrasive detergent for it will damage the hood.



Note
Make sure that cooker hood is shut down before cleaning.

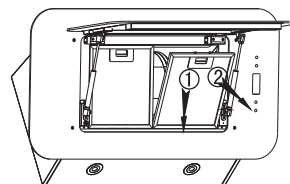

Pic 11

• INSTALLING THE CARBON FILTER (OPTIONAL), SEE PIC.12

— Remove the filters see *Pic.11*.

— The charcoal filters (*Pic.12*) are located at either end of the motor. Turn the charcoal filters anti-clockwise until they are unscrewed.

— Apply reverse procedure to uninstall the charcoal filter.

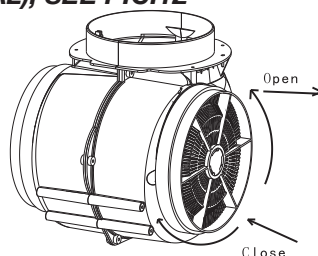

Pic 12



Warning:
the charcoal cannot be washed or re-cycled. It should be changed at three or six months according to your cooking habit

• CHANGING THE LIGHT BULB



Warning:
The power supply must be turned off before changing the light bulb, either by removing the plug or by using the circuit breaker switch.

Take the bracket and glass off and then take the broken light bulb off, See *Pic. 13*.
Fix the new light bulb,glass and bracket on.

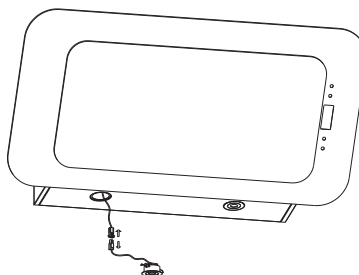

Pic 13

**Warning**

Before carrying out any work, the power supply to the hood must be turned off, either by unplugging it or by using the circuit breaker switch.

- MAINTAINING YOUR APPLIANCE**

MAINTENANCE	WHAT TO DO	PRODUCTS / ACCESSORIES TO USE
Top surface and accessories	Never use metal scouring pads, abrasive products or excessively stiff brushes.	To clean the body and the lighting port, you should use only commercial household cleaning products diluted in water and then rinse using clean water, drying with a soft cloth.
Filter cartridge	This filter traps fatty vapours and dust. This component plays an important role in ensuring the effectiveness of your hood. In the event of tough stains, use a non-abrasive cream, then rinse with clean water.	Use a commercial household cleaning product then rinse abundantly and dry. These filters can be cleaned in a vertical position in your dishwasher. (Do not allow them to touch dirty dishes or silverware.)
Activated carbon filter	This filter traps odours and must be changed at least once a year depending on your level of use. You should order these filters from your dealer (quoting the reference shown on the identification plate located inside the hood) and note the date the filter was changed.	

SYMPTOMS	SOLUTIONS
The hood is not working...	Ensure that: <ul style="list-style-type: none"> • The power is not cut off. • A speed has been selected.
The hood is not operating effectively...	Ensure that: <ul style="list-style-type: none"> • The selected motor speed is sufficient for the quantity of smoke and vapours to be cleared. • The kitchen is sufficiently ventilated to allow for fresh air intake. • The carbon filter is not worn (hood operating in recycling mode).
The hood stopped working	Ensure that: <ul style="list-style-type: none"> • The power is not cut off. • The single-pole cut-off device was not activated.

Any maintenance on your equipment should be undertaken by:

- either your dealer,
- or another qualified mechanic who is an authorized agent for the brand appliances.

When making an appointment, state the full reference of your equipment (model, type and serial number). This information appears on the manufacturer's nameplate attached to your equipment.

This device complies with the delegated regulations (EU) 65/2014 and 66/2014 of the European Commission on the eco design requirements and energy labeling of household hoods.

	symbol	Value	Unit
Brand	Brandt		
Model number	BHV6661B		
Annual energy consumption	AEC	61.6	kWh/annum
Energy efficiency index	EEi	68.1	-
Fluid dynamic efficiency index	FDE	21.0	-
Lighting efficiency index	LE	51.2	-
Grease filtering efficiency	GFE	54.7	-
Time increase factor	<i>f</i>	1.2	-
Maximum volumetric airflow of the cooker hood	Q_{\max}	547.2	m ³ /h
Volumetric airflow at best efficiency point	Q_{BEP}	294.0	m ³ /h
Static pressure at the best efficiency point	P_{BEP}	336	p
Power consumption at the best efficiency point	W_{BEP}	130.7	W
Nominal power consumption of lighting system	W_L	6.0	W
Average illumination of the lighting system	E_{middle}	307	Lux/W
Power consumption in off mode	P_o	0.00	W
Power consumption in standby mode	P_s	0.44	W
Volumetric airflow at the highest speed setting in normal use	-	524.4	m ³ /h
Volumetric airflow at the lowest speed setting in normal use	-	313.8	m ³ /h
Volumetric airflow in intensive or boost mode	-	--	m ³ /h
Sound power emissions at the highest speed setting in normal use	-	69	dB(LWA)
Sound power emissions at the lowest speed setting in normal use	-	57	dB(LWA)
Sound power emissions in intensive / boost mode	-	--	dB(LWA)

	symbol	Value	Unit
Brand	Brandt		
Model number	BHV6961B		
Annual energy consumption	AEC	93.0	kWh/annum
Energy efficiency index	EEI	81.6	-
Fluid dynamic efficiency index	FDE	16.8	-
Lighting efficiency index	LE	38.8	-
Grease filtering efficiency	GFE	53.4	-
Time increase factor	f	1.4	-
Maximum volumetric airflow of the cooker hood	Q_{\max}	632.8	m ³ /h
Volumetric airflow at best efficiency point	Q_{BEP}	364.2	m ³ /h
Static pressure at the best efficiency point	P_{BEP}	288	P
Power consumption at the best efficiency point	W_{BEP}	173.5	W
Nominal power consumption of lighting system	W_L	6.0	W
Average illumination of the lighting system	E_{middle}	233	Lux/W
Power consumption in off mode	P_o	0.00	W
Power consumption in standby mode	P_s	0.44	W
Volumetric airflow at the highest speed setting in normal use	-	597.6	m ³ /h
Volumetric airflow at the lowest speed setting in normal use	-	425.4	m ³ /h
Volumetric airflow in intensive or boost mode	-	--	m ³ /h
Sound power emissions at the highest speed setting in normal use	-	72	dB(LWA)
Sound power emissions at the lowest speed setting in normal use	-	60	dB(LWA)
Sound power emissions in intensive / boost mode	-	--	dB(LWA)